

# LAMPSON-MEGALIFT

# LAMPSON

[www.lampson.com.au](http://www.lampson.com.au)



Contact Lampson-Megalift  
NSW, Newcastle: 02-4959-6222  
NSW, Sydney: 02-9821-2225  
VIC, Melbourne: 03-9857-0356  
QLD, Gladstone: 07-4975-6400  
WA, Perth: 08-9279-2405  
WA, Karratha: 08-9144-4415



ISO 9001.2008 Quality Endorsed  
Heavy Lift Cranes  
Self-Propelled Trailers  
Crawler Transporters  
Turn-key Project Logistics  
Transport and Heavy Lift Engineering

Australia's Largest Fleet of Heavy Lift and Transport Equipment



## LAMPSON SOLUTIONS

- HEAVY LIFT AND PROJECT CRANE HIRE
- HEAVY TRANSPORT AND LOGISTICS
- ENGINEERING DESIGN AND FABRICATION
- JACKING & SKATING SYSTEMS
- INNOVATIVE SOLUTIONS
- SPECIALISED PROJECT MANAGEMENT



## Lampson at work for you

### CONNECTING YOUR BUSINESS TO THE RESOURCES YOU NEED

Lampson (Australia) Pty Ltd and logistics subsidiary Megalift Pty Ltd are quality endorsed and committed to providing the very best of heavy lift and transport equipment and services to the Australasian market. Specialists in heavy lifting and transportation, Lampson have executed projects in the toughest of Australian environments. This profile briefly outlines Lampson's products and services and illustrates some of the solutions provided across various industries.

### LAMPSON EQUIPMENT AND SERVICE RANGE INCLUDES:

- Pre-construction concepts and innovative ideas
- Feasibility studies
- Engineering lift studies and rigging design
- Heavy transportation engineering and logistics
- Turn-key operations of lifting and transportation co-ordination
- Supply of matting, rigging, carriers, jacking and skating systems
- Bare and Dry Crane rental
- Supply of operator and rigging personnel on Lampson equipment
- Logistics for OS import, shipping, barging and installation

### Crawler Cranes

Lampson's fleet of cranes range:-  
50 to 750 tonne Manitowoc  
350 to 2600 tonne Lampson Transi-Lift

Our extensive fleet size provides our customers with greater equipment availability

- OEM designed for Pick and Carry



Lifting Solutions



## TRUCK AND SELF PROPELLED TRAILERS

High capacity modular trailers have revolutionised the movement of mining and process modules on and off Australian roads.

### LAMPSON HEAVY HAULAGE

- Versatile fleet of modular trailers
- Specialist In-house Engineering
- Alternative Lifting and Jacking
- Lampson's ingenuity has resulted in the development of many cost effective transport solutions and some of the largest moves successfully completed in Australia



## HEAVY TRANSPORT AND LOGISTICS

The transport fleet includes:

- Truck and self-propelled modular trailers
- Limitless axle combinations and configurations with modular assembly
- Lightweight on-road trailers equipment and logistics management
- Cometto, Nicolas and Goldhofer modular trailers
- Heavy duty off-road trailer equipment for mine site relocations
- Self Propelled Goldhofer heavy duty high capacity trailers
- Shovel relocation loading equipment and tractors

Crawler Transporters — up to 2000 tonne capacity per unit

- Unique Lampson designed dragline relocation system

- Transporting of draglines and face shovels on crawlers or SPMT
- 6000 tonne capacity on Lampson designed load spreaders
- Travel speeds up to 10km/hr
- Thorough engineering studies, route selection and permits

## DRAGLINE & SHOVEL RELOCATION



Leaders in Heavy Transport







## **PROJECT: NCIG and PWCS Coal Export Facilities**

### **LOCATION: Newcastle, NSW**

Across the sites Lampson supplied over 20 cranes concurrently ranging from the 750 tonne capacity Manitowoc 18000 Max-er, 600 tonne capacity Manitowoc 4600 Ringer and 400 tonne capacity Manitowoc 16000. The latest 200 tonne capacity model Manitowoc 14000's and 275 tonne capacity Manitowoc 2250 cranes plus Rough Terrain models from 30 to 110 tonne capacity were among the other cranes supplied to the coal terminal upgrade.

The Manitowoc Max-er and Ringer attachments utilised on the 18000, 16000, 2250 and 4600 models allow the basic crane to be upgraded to higher capacities. These attachments are cost effective and increase the versatility of the basic cranes provided to the project.



Project Specific





## NCIG and PWCS Coal Export Facility Upgrade

Lampson was proud to supply an array of cranes together with transport, rigging and jacking equipment as well as expert operational personnel to the NCIG and PWCS projects on Kooragang Island, Newcastle, NSW.

Lampson's specialised engineering expertise was utilised by site contractors to develop innovative ideas into cost saving results.



Project Specific





## LAMPSON ENGINEERING

Engineering is a defining component of Lampson's core competencies. Innovation by specialised heavy lift and transport professionals is the source of success to this global organisation.

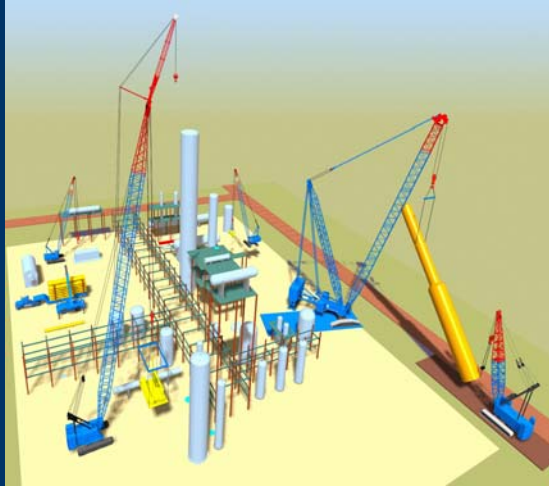

## LAMPSON RIGGING

Engineering design and fabrication of specialised rigging equipment is an intrinsic part of Lampson's heavy lift service.



## LAMPSON TRANSI-LIFT®

The LTL model cranes are designed and constructed by Lampson - their prime application is extremely heavy lifting and travel with loads. Large vessel upending, super 'PAM' pre-assembled modular construction and installation.

Lampson operate 2 x LTL-2600 cranes in Australia and other heavy lift models include the LTL-1100, LTL-850, LTL-750 and LTL-350.

The Transi-Lift attachment converts smaller crawler cranes into heavy lifting machines — versatile equipment represents increasing savings to projects.

Transi-Lift Cranes are effective on power stations and refinery sites that can require long radius and high capacity lifting capabilities.



World Leaders in Heavy Lift



## JACKING AND SKATING SYSTEMS

Lampson have developed several jacking and skating systems to provide a variety of solutions to traditional lifting and jacking projects. Our jacking and skating equipment is prepared to accept components upon arrival and minimises the expense of unloading.

## FACE SHOVELS AND OTHER MINING EQUIPMENT

Electric face-shovel and dragline shut-downs are an expensive however necessary operation; Lampson's development of the Laser Guided Jacking System provides the fastest jacking solution available without compromise for safety.



## GENERATORS AND POWER STATIONS

Lampson developed Jacking Systems provide alternative lifting solutions for lifting equipment from transport, for installation or for maintenance.

Lampson Innovation





# LAMPSON MEGALIFT

[www.lampson.com.au](http://www.lampson.com.au)



## Lampson Solutions

### Lampson Transi-Lift Crawler Cranes:

- 350 tonne to 2600 tonne

### Manitowoc Cranes:

- 50 tonne to 750 tonne

### Grove Rough Terrain Cranes:

- 30 tonne to 110 tonnes

### SPMT and Platform Trailers:

- Goldhofer, Cometto & Nicolas

### Jacking Systems:

- Shovel Jacking System
- Dragline Jacking
- Conveyor and Equipment Jacking

### Crawler Transporters:

- 400 tonne to 2000 tonne

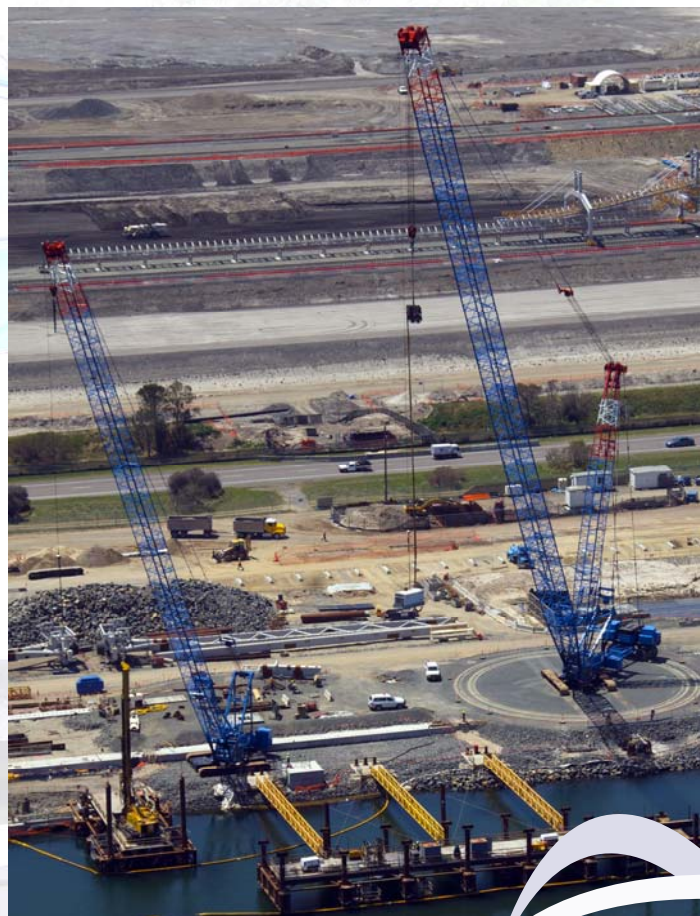

Lampson Delivers

